

Nm

- ◆ Self-locking
- ◆ Replace each time after removing
- ◆ When loosening and tightening counter hold on guide pin

replacement
⇒ [Page 46-
52](#)

46-31

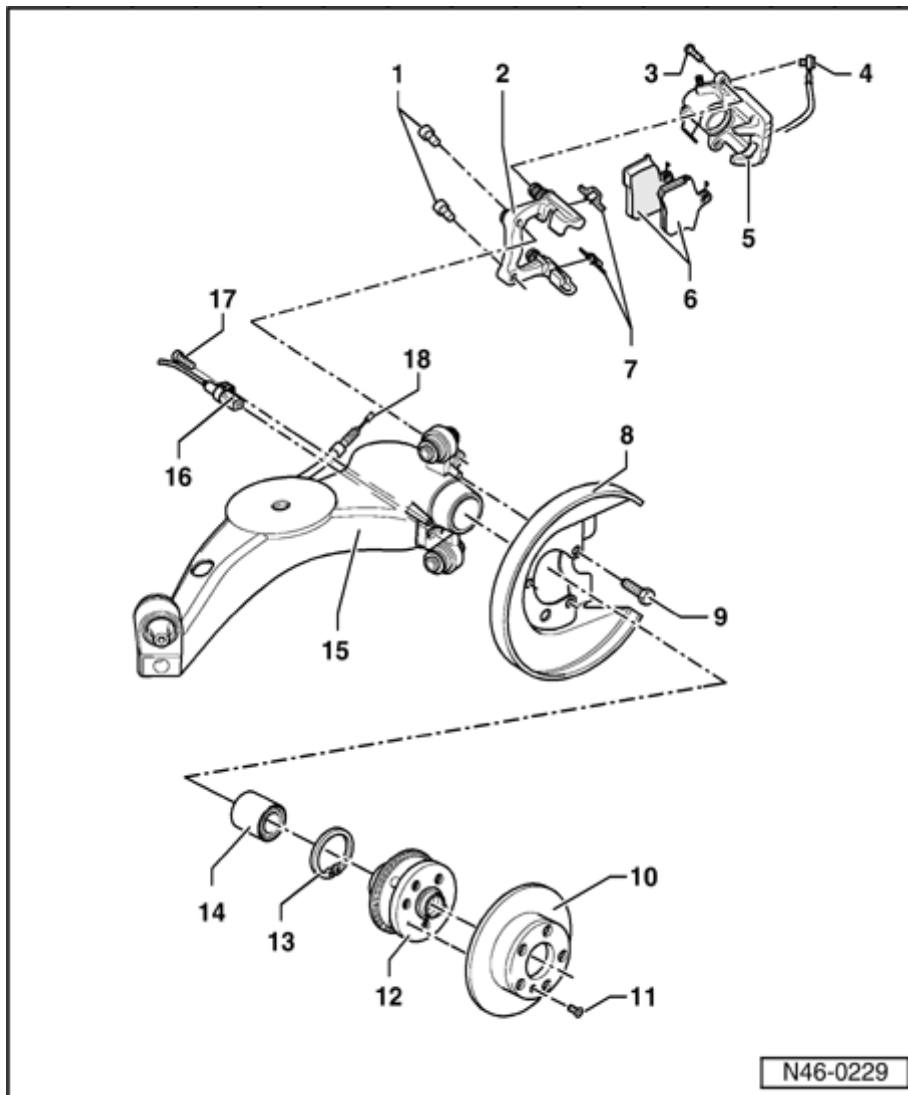

6 - Brake pads

- ◆ Pad thickness, wear limit
⇒ [Page 00-5](#)
- ◆ Different versions possible

⇒ [Parts List](#)

- ◆ Checking pad thickness:

⇒ [Maintenance](#)

- ◆ Removing and installing
⇒ [Page 46-34](#)

- ◆ When worn always replace both sides

7 - Pad retaining springs

- ◆ Always replace when changing pads

8 - Backing plate

- 9 - Bolt - 10 Nm

[Manual,](#)
[Suspension,](#)
[Wheels,](#)
[Steering,](#)
[Repair Group](#)
[42](#)

13 - Circlip

46-33

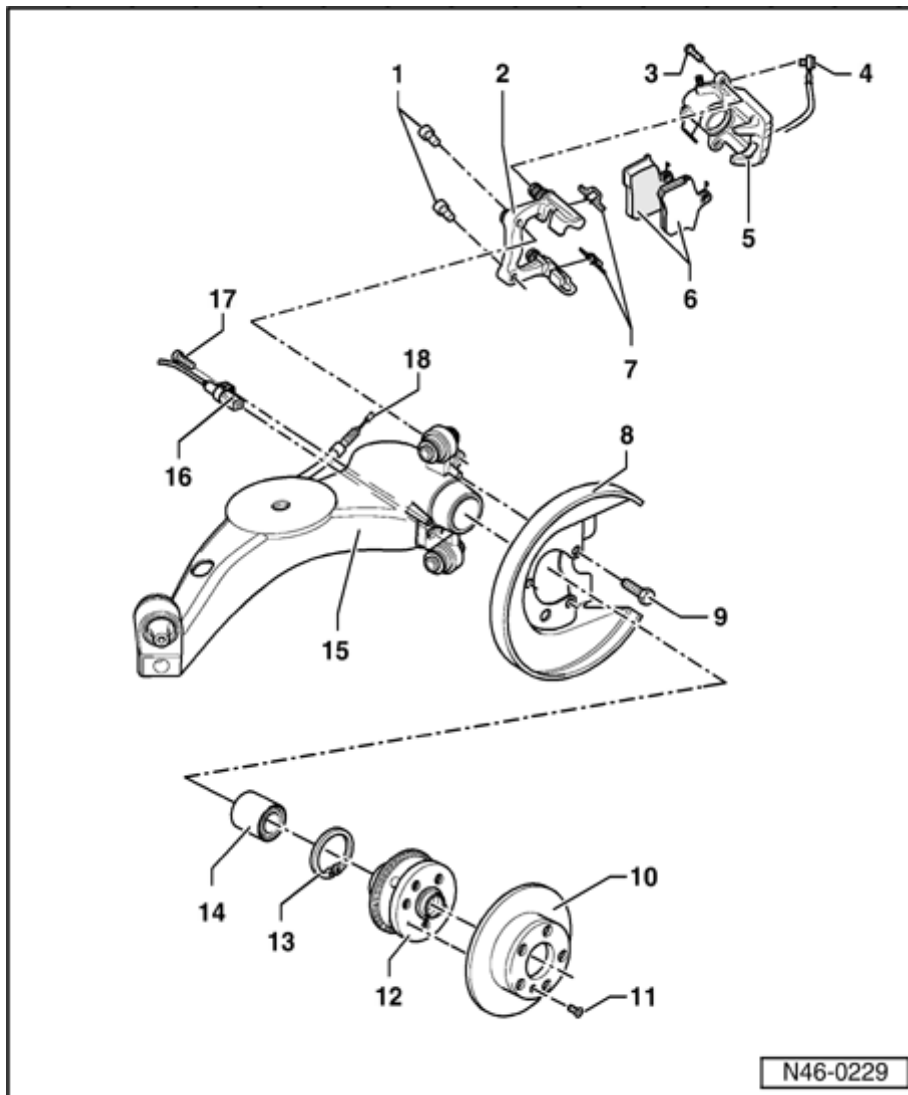

14 - Wheel bearing

- ◆ Removing and installing:

⇒ [Repair Manual, Suspension, Wheels, Steering, Repair Group 42](#)

15 - Trailing arm

16 - Speed sensor

- ◆ Removing and installing ⇒ [Page 45-56](#) and ⇒ [Page 45-116](#)

17 - Hex head bolt

- ◆ Tightening torque ⇒ [page 45-5](#) and ⇒ [Page 45-116](#)

18 - Parking brake cable

- ◆ Removing and installing ⇒ [Page 46-48](#)

- ◆ Adjusting parking brake ⇒

[Page 46-52](#)

Brake pads - vehicles with all wheel drive, removing and installing

Special tools and equipment

- ◀ ◆ 3272 Piston compressing and extracting tool

Removing

- Remove wheels.

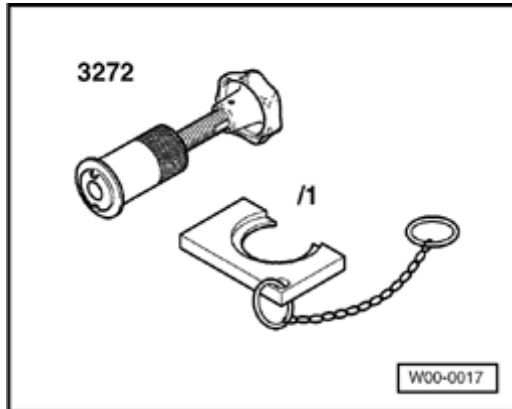

- ◀ - Pry off clip -1- for parking brake cable.
- Press brake lever -2- in direction of arrow and unhook brake cable -3-.

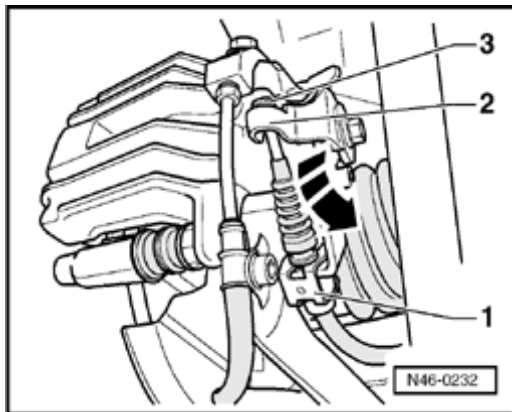

46-35

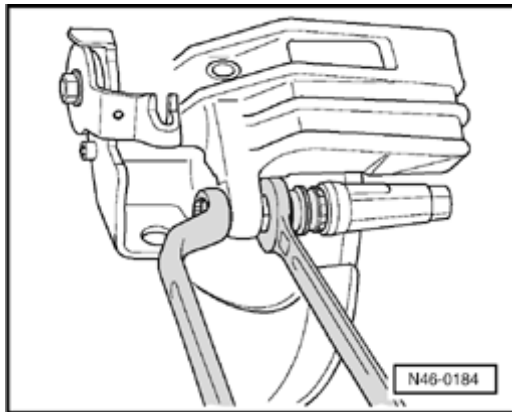

- Counterhold guide pin, to detach brake caliper housing.
- Secure brake caliper housing on vehicle with wire.

Note:

Do not twist or kink brake hose/line.

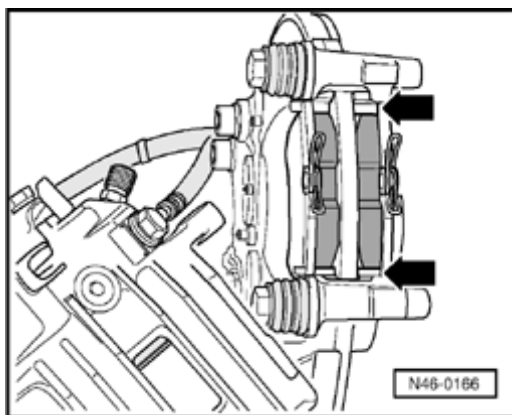

- Remove brake pads and pad retaining springs -arrows-.

Note:

If reusing brake pads mark location and install in same position when installing, otherwise it will cause uneven braking!

Installing

Install in reverse sequence; note the following points:

- Clean brake caliper housing, in particular the bonding surface for the brake pad. It must be free of adhesive and grease residues.

Use methylated spirit only for cleaning the brake caliper housing.

Note:

Prior to pressing the piston back, draw off brake fluid from the reservoir. Use a bleeder bottle or a plastic bottle which is only used for brake fluid.

WARNING!

Brake fluid is poisonous and must under no circumstances be siphoned via a hose with the mouth.

46-37

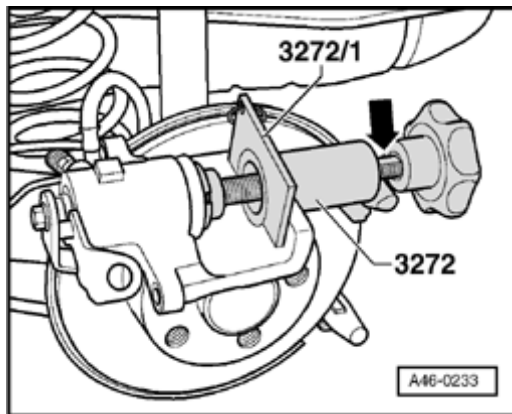

- Apply special tool 3272 together with 3272/1 to piston on brake caliper housing.
- Screw in piston by turning knurled wheel of special tool 3272 clockwise, do not damage protective cap when doing this.

Note:

If piston is stiff, use a 13 mm open-ended wrench to be applied at appropriate flats -arrow-.

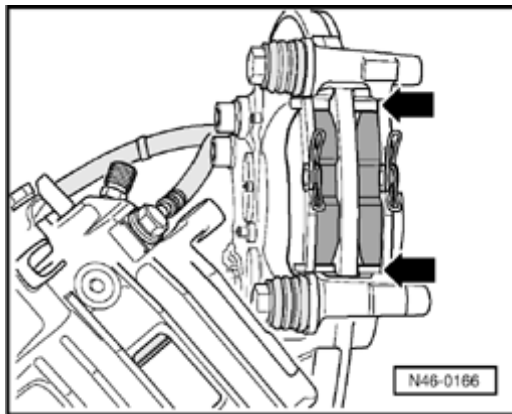

- Insert brake pads and brake pad retaining springs -arrows- into brake carrier.
- Pull protective foil off outer brake pad backplate.
- Secure brake caliper housing with new self-locking bolts.

Note:

The repair kit contains four self-locking hex bolts, which must always be installed.

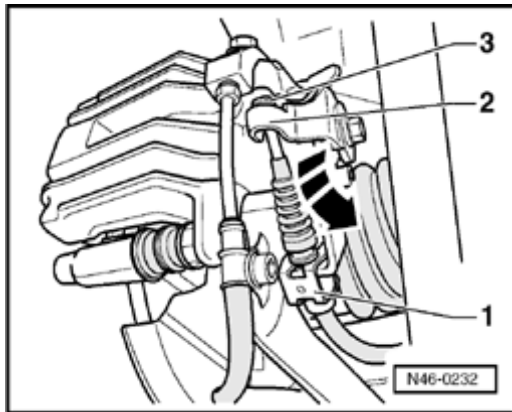

- Press brake lever -2- in direction of arrow and attach parking brake cable.
- Open clip -1- securing parking brake cable.

WARNING!

After installing brake pads, press brake pedal firmly several times with vehicle stationary to ensure that brake pads become properly seated.

- Check brake fluid level and top off, if necessary.

Tightening torque

Component	Nm
Brake caliper housing to brake carrier	35 1)

1) Replace bolts

Brake caliper - vehicles with all wheel drive, removing and installing

Special tools and equipment

- ◆ Brake pedal depressor VAG 1869/2

Removing

- Remove brake pads ⇒ [Page 46-34](#) .

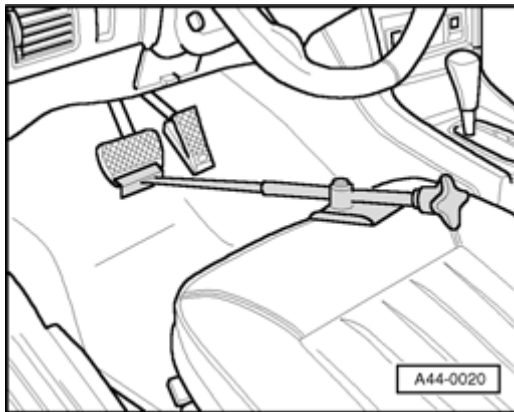

- Insert brake pedal depressor VAG 1869/2 between brake pedal and driver's seat. Depress the brake pedal by at least 60 mm.

Note:

Pressing down the brake pedal closes the valves in the brake master cylinder to prevent the brake fluid reservoir from running dry.

- Connect bleeder bottle hose to bleeder screw of removed brake caliper.
- Open bleeder screw.
- Do not remove brake pedal depressor VAG 18169/2.
- Unscrew brake hose from brake caliper.

Installing

Install in reverse sequence; note the following points:

- Install brake pads ⇒ [Page 46-36](#) .
- After servicing or replacing, new brake caliper, parking brake cable must be adjusted. Adjust parking brake ⇒ [Page 46-52](#) . Do not press foot brake until parking brake has been adjusted.
- Bleed brake system: ABS/ESP Mark 20 ⇒ [Page 47-17](#) , ABS/ESP Mark 60 ⇒ [Page 47-31](#) .

Tightening torque

Component	Nm
Brake hose to brake caliper	38 ¹⁾

¹⁾ Always replace brake hose/line with banjo bolt after removing banjo bolt.